

TYPICAL CROSS SECTION

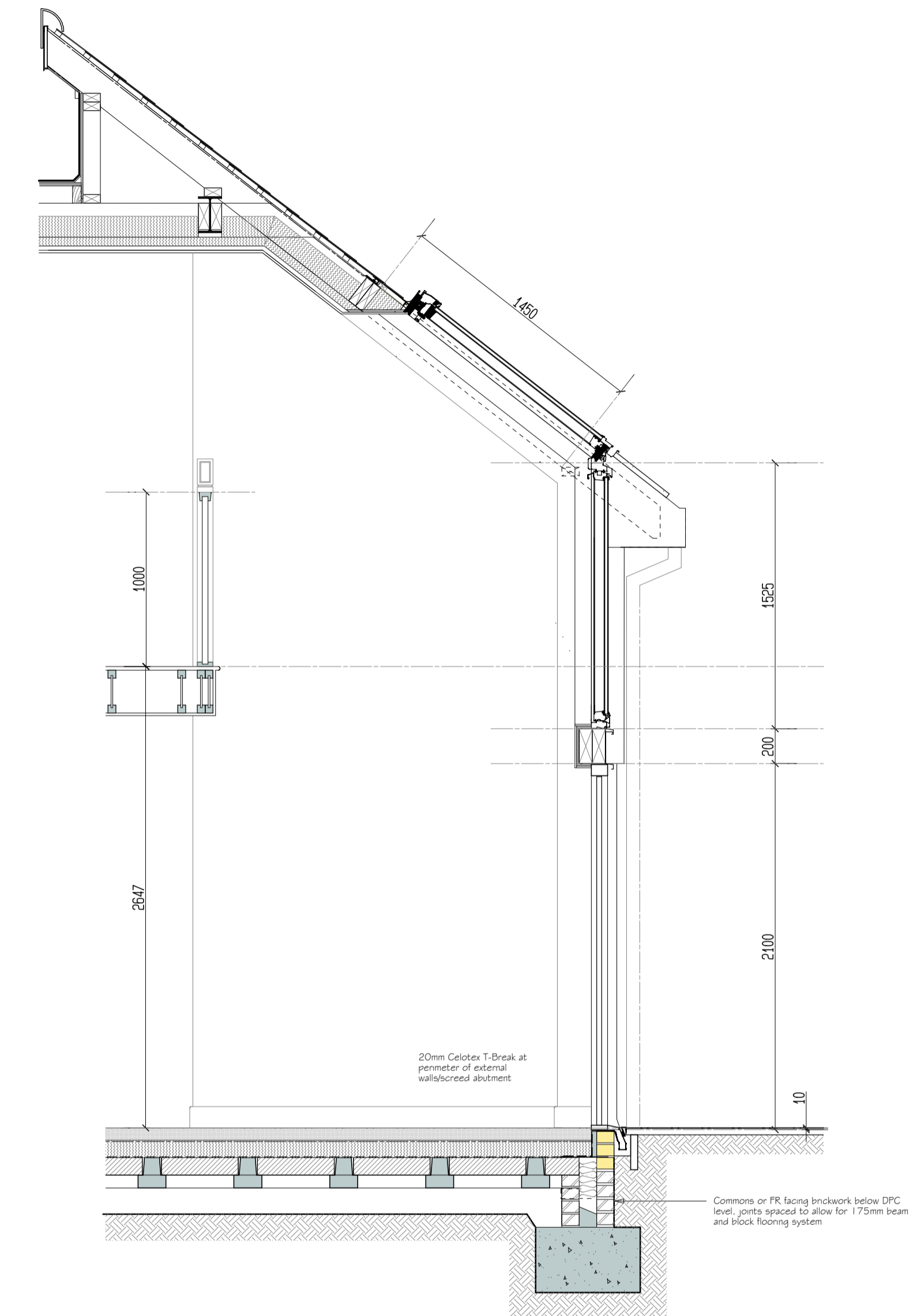

ENTRANCE SCREEN SECTION

PROPOSED SECTIONS 1:25 @ A1

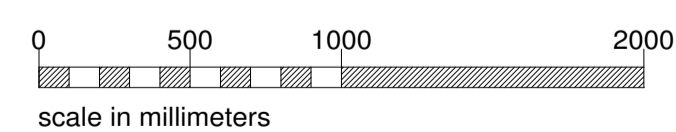

SUMMARY OF DESIGN THERMAL VALUES	
BEAM AND BLOCK FLOORS	0.16W/sqMk
MASONRY FULL FILL CAVITY WALLS	0.24W/sqMk
PITCHED COLD ROOF (INSULATION AT RAFTER LEVEL)	0.14W/sqMk
FLAT COLD ROOF (INSULATION AT CEILING LEVEL)	0.20W/sqMk
AVERAGE WINDOWS	1.40W/sqMk
AVERAGE DOORS	1.60W/sqMk
HEATING SYSTEM	CHES5 - HR6 (2005)
Gas fired boiler(min 90% efficient) + wet heating system	
SECONDARY HEATING SOURCE	HETAS Approved closed log burner
AIR PERMEABILITY (Design rate)	7M3/2hr@50Pa

No.	DATE	AMENDMENT	BY
A	15/02/11	Issued for Building Regulations.	CT
B	9/03/11	Roof windows shown on section and entrance screen added	CT
C	17/11/11	'AS BUILT' PLANS	CT

PROPOSED SECTIONS		
Project Name		
Proposed new dwelling Land R/O 47 London Road, Harston, Cambs. For: Simpers Ltd		
Drawing No.	Rev No.	Date
09:165/18	C	Feb. 2011
Scale	1:25 @ A1 size sheet.	
CHRIS TODD M.C.I.A.T CHARTERED ARCHITECTURAL TECHNOLOGIST 23 St. Audreys Close, Histon, Cambs. CB4 9JX Tel: 01223 504199		